

# ROLLER FOLLOWERS

SEPARABLE WITH INNER RING WITH SHIELD

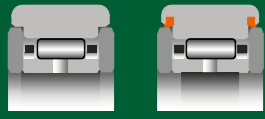

NAST..ZZ

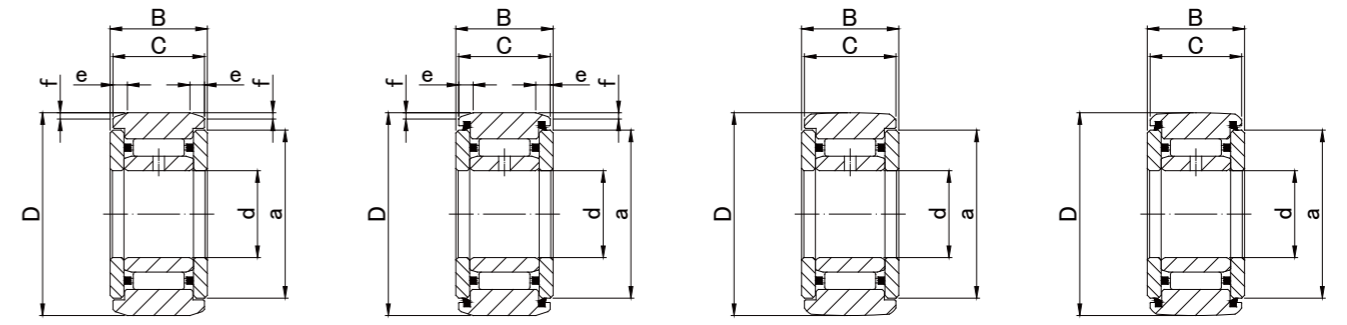

NAST..ZZ

NAST..ZZUU

NAST..ZZR

NAST..ZZUUR

## NAST..ZZ TYPE

Prepacked Grease

Shaft Diameter (mm)	Designation				Dimensions (mm)									Basic dynamic load rating	Basic static load rating	Track load capacity		Limiting speed *	Mass	
	Cylindrical outer ring		Crowned outer ring (R500)		d	D	B	C	a	e	f	r/s min	Cr N			Cor N	Cylindrical outer ring			Crowned outer ring
	Without seals	With seals	Without seals	With seals													N			N
<b>6</b>	<b>NAST 6ZZ</b>	<b>NAST 6ZZUU</b>	<b>NAST 6ZZR</b>	<b>NAST 6ZZUUR</b>	6 <sup>0</sup> <sub>-0.008</sub>	<b>19</b>	14	13.8	14	2.5	0.8	0.3	4 120	4 550	3 530	1 370	20 000	24.5		
<b>8</b>	<b>NAST 8ZZ</b>	<b>NAST 8ZZUU</b>	<b>NAST 8ZZR</b>	<b>NAST 8ZZUUR</b>	8 <sup>0</sup> <sub>-0.008</sub>	<b>24</b>	14	13.8	17.5	2.5	0.8	0.6	5 680	5 890	4 510	1 860	17 000	39		
<b>10</b>	<b>NAST10ZZ</b>	<b>NAST10ZZUU</b>	<b>NAST10ZZR</b>	<b>NAST10ZZUUR</b>	10 <sup>0</sup> <sub>-0.008</sub>	<b>30</b>	16	15.8	23.5	2.5	0.8	1	9 700	9 670	6 860	2 450	15 000	65		
<b>12</b>	<b>NAST12ZZ</b>	<b>NAST12ZZUU</b>	<b>NAST12ZZR</b>	<b>NAST12ZZUUR</b>	12 <sup>0</sup> <sub>-0.008</sub>	<b>32</b>	16	15.8	25.5	2.5	0.8	1	10 400	10 900	7 350	2 740	13 000	75		
<b>15</b>	<b>NAST15ZZ</b>	<b>NAST15ZZUU</b>	<b>NAST15ZZR</b>	<b>NAST15ZZUUR</b>	15 <sup>0</sup> <sub>-0.008</sub>	<b>35</b>	16	15.8	29	2.5	0.8	1	12 300	14 300	8 040	3 140	10 000	83		
<b>17</b>	<b>NAST17ZZ</b>	<b>NAST17ZZUU</b>	<b>NAST17ZZR</b>	<b>NAST17ZZUUR</b>	17 <sup>0</sup> <sub>-0.010</sub>	<b>40</b>	20	19.8	32.5	3	1	1	17 400	20 900	11 800	3 720	9 500	135		
<b>20</b>	<b>NAST20ZZ</b>	<b>NAST20ZZUU</b>	<b>NAST20ZZR</b>	<b>NAST20ZZUUR</b>	20 <sup>0</sup> <sub>-0.010</sub>	<b>47</b>	20	19.8	38	3	1	1	19 200	24 500	13 800	4 610	8 500	195		
<b>25</b>	<b>NAST25ZZ</b>	<b>NAST25ZZUU</b>	<b>NAST25ZZR</b>	<b>NAST25ZZUUR</b>	25 <sup>0</sup> <sub>-0.010</sub>	<b>52</b>	20	19.8	43	3	1	1	20 700	28 400	15 300	5 290	7 000	225		
<b>30</b>	<b>NAST30ZZ</b>	<b>NAST30ZZUU</b>	<b>NAST30ZZR</b>	<b>NAST30ZZUUR</b>	30 <sup>0</sup> <sub>-0.010</sub>	<b>62</b>	25	24.8	50.5	4	1.2	1	30 300	45 400	22 100	6 660	5 500	400		
<b>35</b>	<b>NAST35ZZ</b>	<b>NAST35ZZUU</b>	<b>NAST35ZZR</b>	<b>NAST35ZZUUR</b>	35 <sup>0</sup> <sub>-0.012</sub>	<b>72</b>	25	24.8	53.5	4	1.2	1	32 200	50 600	25 700	8 130	5 000	550		
<b>40</b>	<b>NAST40ZZ</b>	<b>NAST40ZZUU</b>	<b>NAST40ZZR</b>	<b>NAST40ZZUUR</b>	40 <sup>0</sup> <sub>-0.012</sub>	<b>80</b>	26	25.8	61.5	4	1.2	1.5	35 700	61 100	30 300	9 310	4 000	710		
<b>45</b>	<b>NAST45ZZ</b>	<b>NAST45ZZUU</b>	<b>NAST45ZZR</b>	<b>NAST45ZZUUR</b>	45 <sup>0</sup> <sub>-0.012</sub>	<b>85</b>	26	25.8	66.5	4	1.2	1.5	37 100	66 400	31 100	10 100	4 000	760		
<b>50</b>	<b>NAST50ZZ</b>	<b>NAST50ZZUU</b>	<b>NAST50ZZR</b>	<b>NAST50ZZUUR</b>	50 <sup>0</sup> <sub>-0.012</sub>	<b>90</b>	26	25.8	76	4	1.2	1.5	38 700	71 800	34 000	11 000	3 500	830		

\* Without seals, suitable for grease lubrication. In case of oil lubrication, up to 130% of this value shall be permissible, and 70% of this value shall apply for types with seals.

### OUTER RINGS TOLERANCE (Outside diameter) (µm)

TYPE	Cylindrical outer ring	Crowned outer ring
NAST6,NAST8,NAST10	0/-9	0/-50
NAST12,NAST15,NAST17,NAST20	0/-11	0/-50
NAST25,NAST30,NAST35,NAST40	0/-13	0/-50
NAST45,NAST50	0/-15	0/-50